

WonderBUILDS

WonderBuilds SA Primer

Fast Drying Synthetic Primer

30
minute
Drying-Time

Bitumen
compatible

Benefits of WonderBuilds SA Primer

Fast Drying Synthetic Primer:

- Improves adhesion
- Compatible with bituminous membranes
- Fast-drying
- Simple application
- Extremely economical

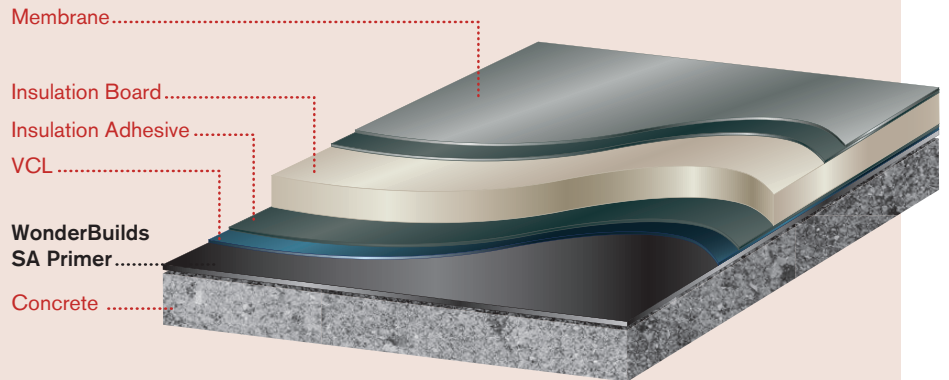

All diagrams are for illustrative purposes only and are not intended to show a precise image of the product.

WonderBuilds SA Primer was specifically formulated to activate self-adhesive roofing membranes.

Ensures successful roofing projects: improves the adhesion properties of roof deck

Failed roofing projects can be costly for your contractor. WonderBuilds SA Primer helps to ensure successful roofing projects by improving the adhesion properties of roof deck. It treats porous and dusty surfaces to provide a long-lasting bond between the roof deck and substrate.

Helps to reduce overall project time: fast-cure time

Time is money to your contractor. WonderBuilds SA Primer has a fast drying-time of 30 minutes. This helps to keep individual task time to a minimum, which enables your contractor to move on to the next stage in the process quickly and reduce overall project time.

Simplifies application tasks: easily brush-applied due to its low viscosity

Your contractor requires no application equipment to apply WonderBuilds SA Primer, which helps to reduce costs. It is easily applied to the surface of the roof deck with a brush or roller due to its low viscosity.

Extremely economical: excellent coverage rate

WonderBuilds SA Primer is extremely economical due to its excellent coverage rate.

WonderBUILDS

WonderBuilds SA Primer

Fast Drying Synthetic Primer

Assessment/Preparation:

1. The surfaces which the primer is to be applied should be dry, clean and free from contamination.
2. Ensure any fixings are not protruding from the deck.

Application:

1. WonderBuilds SA Primer should be applied evenly over the entire surface by brush or roller. Avoid excessive consumption of the primer as this will cause uneven drying of the primer. Ensure the primer is applied into corners and detail areas.
2. The self-adhesive membrane should be applied as soon as the primer is completely dry and consolidated with a roller. If the primer layer becomes contaminated, or left more than 4 hours before applying the membrane, then the

primer should be re-applied to a cleaned surface.

Note: WonderBuilds SA Primer primer should not be applied at temperatures below 5°C.

WonderBuilds SA Primer comes supplied in a 5L screw-top tin and 15L tin plate, which feature a handle for easy pouring.



Technical Data

Base	Synthetic Rubber	Tack-Life	1 hour approx. (20°C)
Solids	34-38%	Drying-Time**	30 minutes approx.
Appearance	Black	Shelf-Life	12-months (5-25°C)
Recommended Coat Weight (per substrate)*	Plywood/OSB: 200gsm approx. Felt: 200gsm approx. Concrete: 200-300gsm approx.	Storage	5-25°C
Application Temperature	5-25°C	Environmental	See MSDS
Viscosity CPS	800-1000CPS (20°C)	Cleaner	Solvent 4

*Coat weights stated are approximate, depending on porosity and type of surface (two coats may be required on very porous surfaces).

**Drying time is approximately 1-hour, which accelerates at elevated temperatures and slows at lower temperatures.

IMPORTANT NOTES:

Temperature and timings: All information on temperature and timings represent normal working conditions and is provided as a guideline only. However, please contact WonderBuilds for advice if you wish to operate outside of these parameters.

Storage and handling: WonderBuilds SA Primer should be stored unopened in a dry condition at a temperature of 5-25°C. WonderBuilds takes every care to ensure that this product reaches you fit for purpose by protecting it with a layer of nitrogen prior to despatch. This ensures a storage life of 12 months, provided that the container is left unopened in a dry condition at a temperature of 5-25°C. The layer of nitrogen will disappear and the product will have a limited life once

the container is opened. It is also important to note that carbon dioxide will be given off if water enters the adhesive container, which can cause pressurisation.

Disclaimer: WonderBuilds has taken care to ensure that the information provided in the literature is correct and up to date. However, it is not intended to form any part of a contract or provide a guarantee. Purchasers/intending purchasers should contact WonderBuilds to check whether there have been any changes to the information since publication of the literature. Please ensure you have read the hazard labels and material safety data sheet before using this product.



Adhesives exceed independent standards for resistance to wind uplift!

WonderBuilds understands that you need assurance products used on site are fit for purpose. This is why we instructed BRE to test roofing systems constructed with our insulation and membrane adhesives for resistance to wind uplift. These systems achieved figures of 5000Pa and -5500Pa.

Tests were devised from BS EN 1991-1-4 *. Expected wind uplift is -1000Pa for London and -2000Pa for Inverness. Therefore, roofing systems

constructed with our adhesives achieved safety factors of 5 and 5.5 for London and 2.5 and 2.75 for Inverness.

All of our products are tested regularly by our technical department. Please call/email us for further information on wind uplift results or other tests we conduct.

*BSI EN 1991-1-4 provides guidance and actions for the structural design of buildings and civil engineering works for wind.